

## Phasing Cylinder Range

### NAP Series

- Standard duty
- Standard bores and strokes

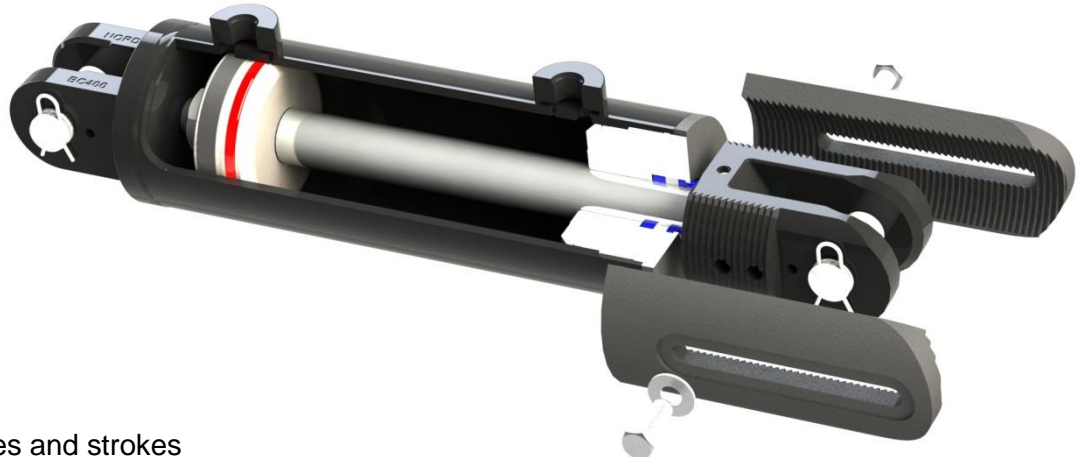

### NHP Series

- Heavy duty
- Standard bores and strokes

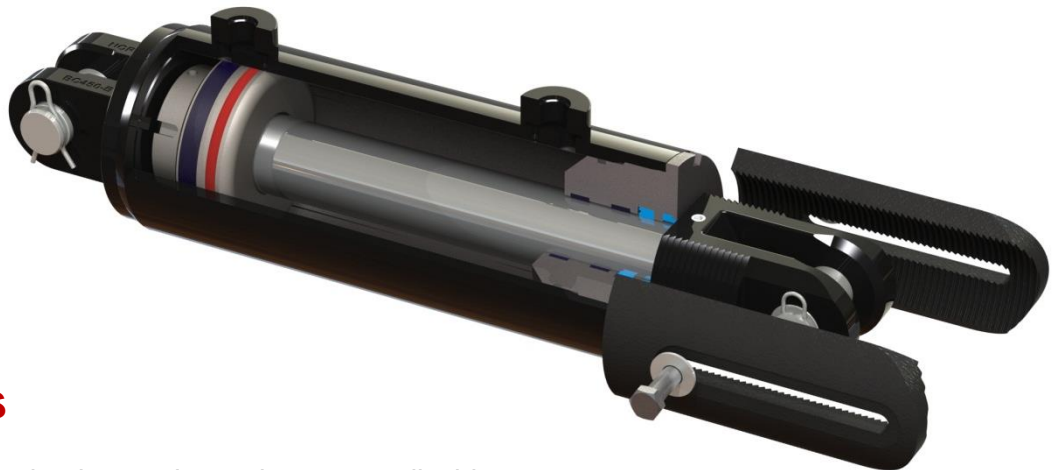

### NIP Series

Configured standard or heavy duty using any applicable Nordon or client specific mountings and non standard stroke lengths



## NAP Series

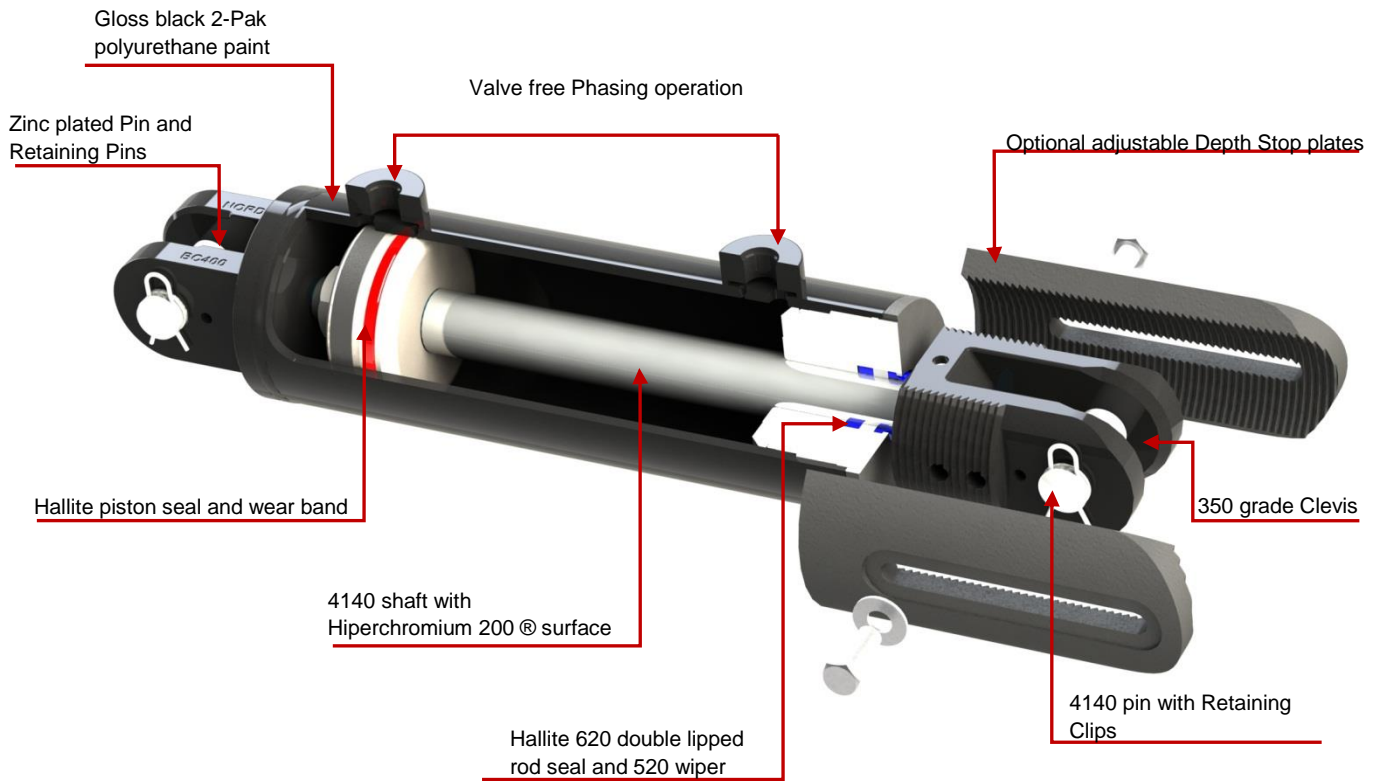

## Nordon Quality

**Nordon exclusive re-phasing ports:**  
No valves to be affected by contamination and no grooves across the piston seal to cause wear.

**High quality skived and roller burnished tube:**  
0.1micron RA surface finish results in extended seal life.

**4140 High Tensile shaft:**  
more than double the tensile and shear strength of standard shafts.

**4140 rod clevis pins:**  
greater wear resistance where it is needed most

**Hiperchrome 200® hard chrome plating:**  
200 hours rating 9 corrosion certification mean enhanced corrosion protection

**Hallite 620 double lipped rod seal:**  
Improved sealing performance over a wider range of operating conditions.

**Hallite 520 rod wiper:**  
Enhanced rod wiping performance and durability.

**350 grade cast steel clevises:**  
Provides greater strength and accuracy

### Available Specifications

<b>Bore</b>	from 3" to 5" in 1/4 " increments
<b>Stroke</b>	8", 12"
<b>Mounts</b>	Female Clevis (both ends)
<b>Depth Stop</b>	from 3.5" to 5" bores
<b>Max Pressure</b>	200* Bar
<b>Max Diff Pressure</b>	100 Bar
<b>Min System Flow</b>	20 ltrs per min
<b>Speed</b>	0.25 meters per second
<b>Duty</b>	Medium
<b>Colour</b>	Gloss Black 2 Pack

15 Johnstone Road, Brendale QLD 4500

P +61 7 3889 6522 | F +61 7 3889 7198

E [sales@nordoncyl.com.au](mailto:sales@nordoncyl.com.au) | W [www.nordoncyl.com.au](http://www.nordoncyl.com.au)

## NAP Technical Specifications

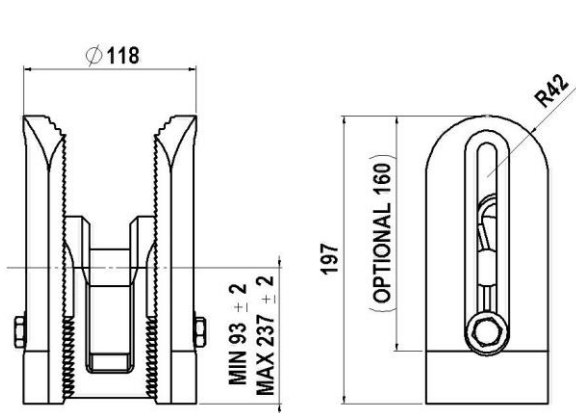

**DEPTH STOP PLATE KIT (OPTIONAL)**

*Not available in 3.0" and 3.25" Bore*

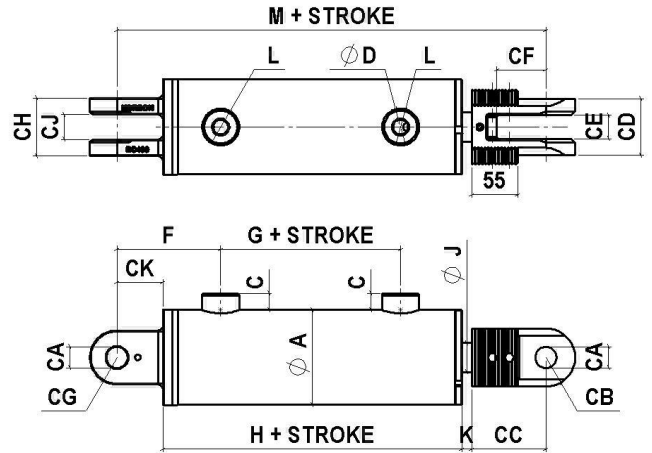

### Depth Stops

Only Nordon Phasing Cylinders can be fitted with a depth stop kit at any time without the need to change the rod clevis.

The Depth Stop Clevises have 4mm pitch on depth engagement teeth allowing for finer adjustment than other products.

Depth stop kits are available in 160mm and 200mm lengths and give extended adjustments range for those who need it.

*Please Contact the Sales Office on 07 3889 6522 for requirements outside of these specifications*

Bore dia	Rod Buckle Max differential piston pressure	
	Stroke	
	16"	18"
3.0"	155	132
3.25"	134	113
3.5"	115	97
3.75"	147	124
4.0"	129	108
4.25"	115	96
4.5"	144	122
4.75"	130	109
5.0"	117	99

Bore dia	Dimensional Data: Closed Centre = 311mm plus Stroke																			
	A	C	D	F	G	H	J	K	L	M	*CA	CB	CC	CD	CE	CF	CG	CH	CJ	CK
3.0"	89	20	45	115	12	145	1.25"	40	3/4 UNO	311	1"	28	75	64	28	45	25	62	28	51
3.25"	95	20	45	119	12	145	1.25"	36	3/4 UNO	311	1"	28	75	64	28	45	33	70	30	55
3.5"	102	20	45	119	13	150	1.25"	17	3/4 UNO	311	1"	35	89	68	28	59	33	70	30	55
3.75"	108	20	45	124	13	150	1.375"	12	3/4 UNO	311	1"	35	89	68	28	59	33	70	30	55
4.0"	114	20	45	124	13	150	1.375"	12	3/4 UNO	311	1"	35	89	68	28	59	33	70	30	55
4.25"	121	20	45	124	13	150	1.375"	12	3/4 UNO	311	1"	35	89	68	28	59	33	70	30	55
4.5"	127	20	45	124	13	150	1.5"	12	3/4 UNO	311	1"	35	89	68	28	59	33	70	30	55
4.75"	133	20	45	124	13	150	1.5"	12	3/4 UNO	311	1"	35	89	68	28	59	33	70	30	55
5.0"	140	20	45	124	13	150	1.5"	12	3/4 UNO	311	1"	35	89	68	28	59	33	70	30	55

Option – 1.25" pins on 3.5" to 5" bore. D9 tolerance on pin holes

## NHP Series

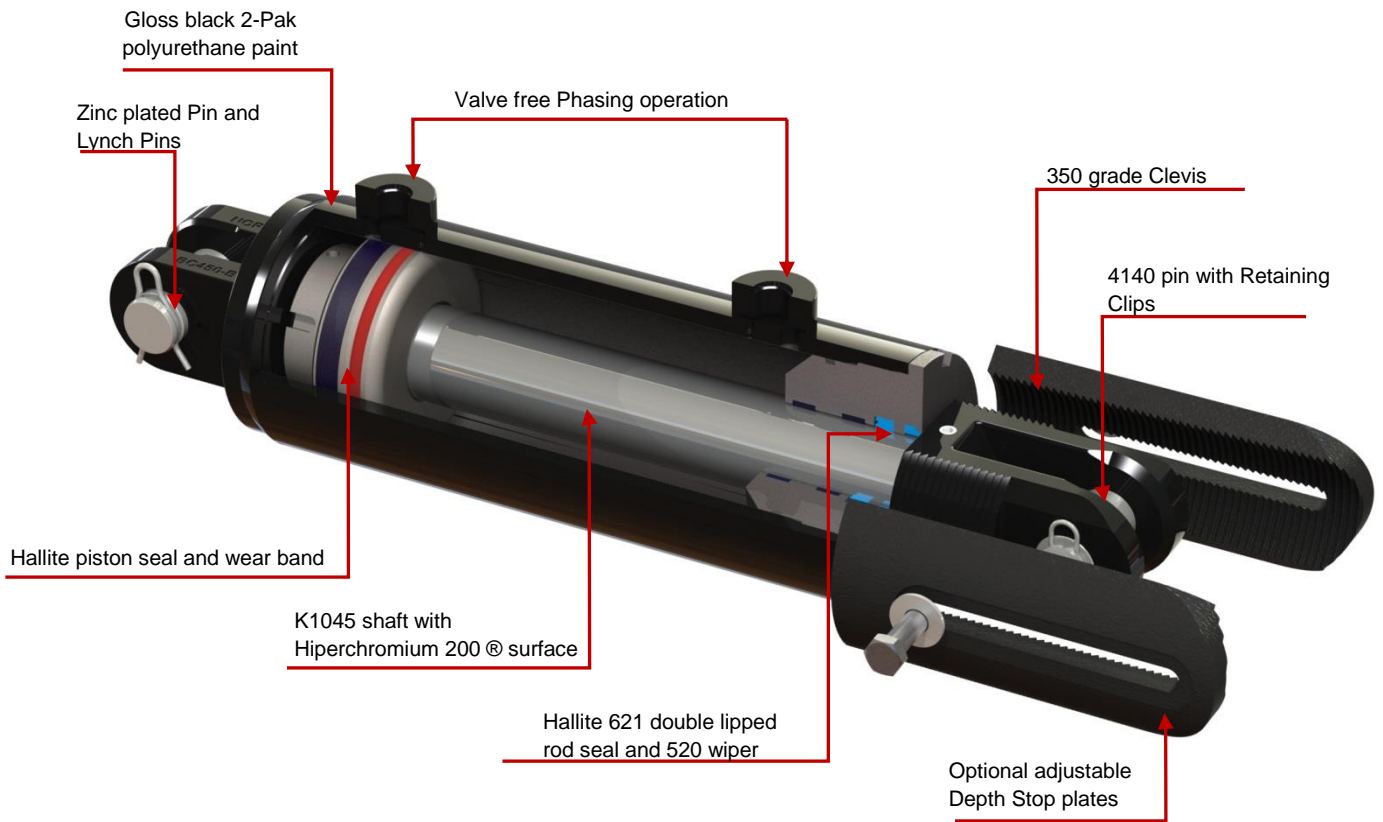

## Nordon Quality

### Nordon exclusive re-phasing ports:

No valves to be affected by contamination and no grooves across the piston seal to cause wear.

### High quality skived and roller burnished tube:

0.1micron RA surface finish results in extended seal life.

### K1045 rod clevis pins:

greater wear resistance where it is needed most

### Hiperchrome 200 @ hard chrome plating:

200 hours rating 9 corrosion certification mean enhanced corrosion protection

### Hallite 621 double lipped rod seal:

Improved sealing performance over a wider range of operating conditions.

### Hallite 520 rod wiper:

Enhanced rod wiping performance and durability.

### 350 grade cast steel clevises:

Provides greater strength and accuracy

Available Specifications	
Bore	from 3" to 5" in 1/2 " increments
Stroke	8", 12", 16" and 18"
Mounts	Female Clevis (both ends)
Depth Stop	from 3.5" to 5.5" bores
Max Pressure	200* Bar
Max Diff Pressure	160 Bar
Min System Flow	20 ltrs per min
Speed	0.25 meters per second
Duty	Heavy
Colour	Gloss Black 2 Pack

## NHP Technical Specifications

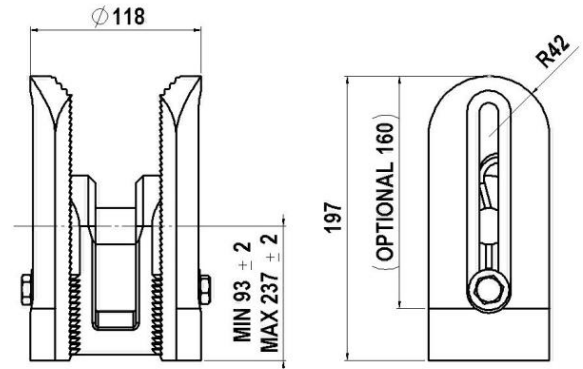
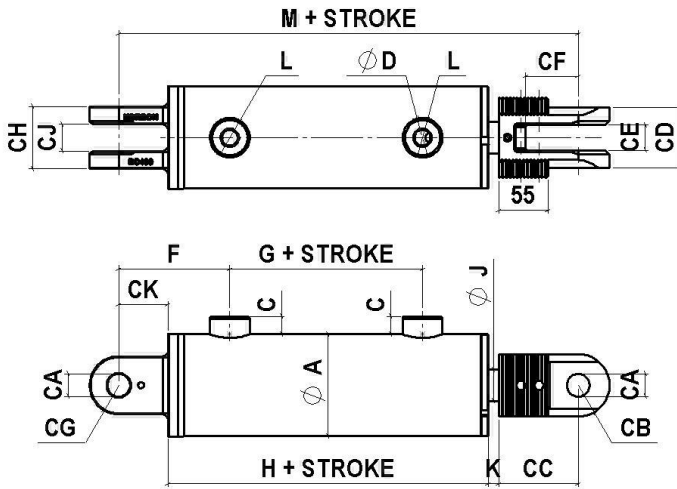

**DEPTH STOP PLATE KIT**

*Not available in 3.0" and 3.25" Bore*

### Depth Stops

Only Nordon NHP Phasing Cylinders can be fitted with a depth stop kit at any time without the need to change the rod clevis.

The Depth Stop Clevises have 4mm pitch on depth engagement teeth allowing for finer adjustment than other products.

Depth stop kits are available in 160mm and 200mm lengths and give extended adjustments range for those who need it.

Bore dia	Dimensional Data: Closed Centre = 311mm plus Stroke																			
	A	C	D	F	G	H	J	K	L	M	*CA	CB	CC	CD	CE	CF	CG	CH	CJ	CK
3.0"	90	20	45	124	12	150	1.625"	18	3/4 UNO	311	1.25"	35	75	64	28	59	33	70	30	55
3.5"	102	20	45	124	12	155	45mm	12	3/4 UNO	311	1.25"	35	89	68	28	59	33	70	30	55
4.0"	114	20	45	124	12	155	50mm	12	3/4 UNO	311	1.25"	35	89	68	28	59	33	70	30	55
4.5"	134	20	45	122	13	163	2.0"	4	3/4 UNO	311	1.25"	35	89	68	28	59	33	70	30	55
5.0"	146	20	45	122	11	163	55mm	4	3/4 UNO	311	1.25"	35	89	68	28	59	33	70	30	55
5.5"	159	20	45	122	11	163	2.25"	4	3/4 UNO	311	1.25"	35	89	68	28	59	33	70	30	55

D9 tolerance on all pins

## NIP Series

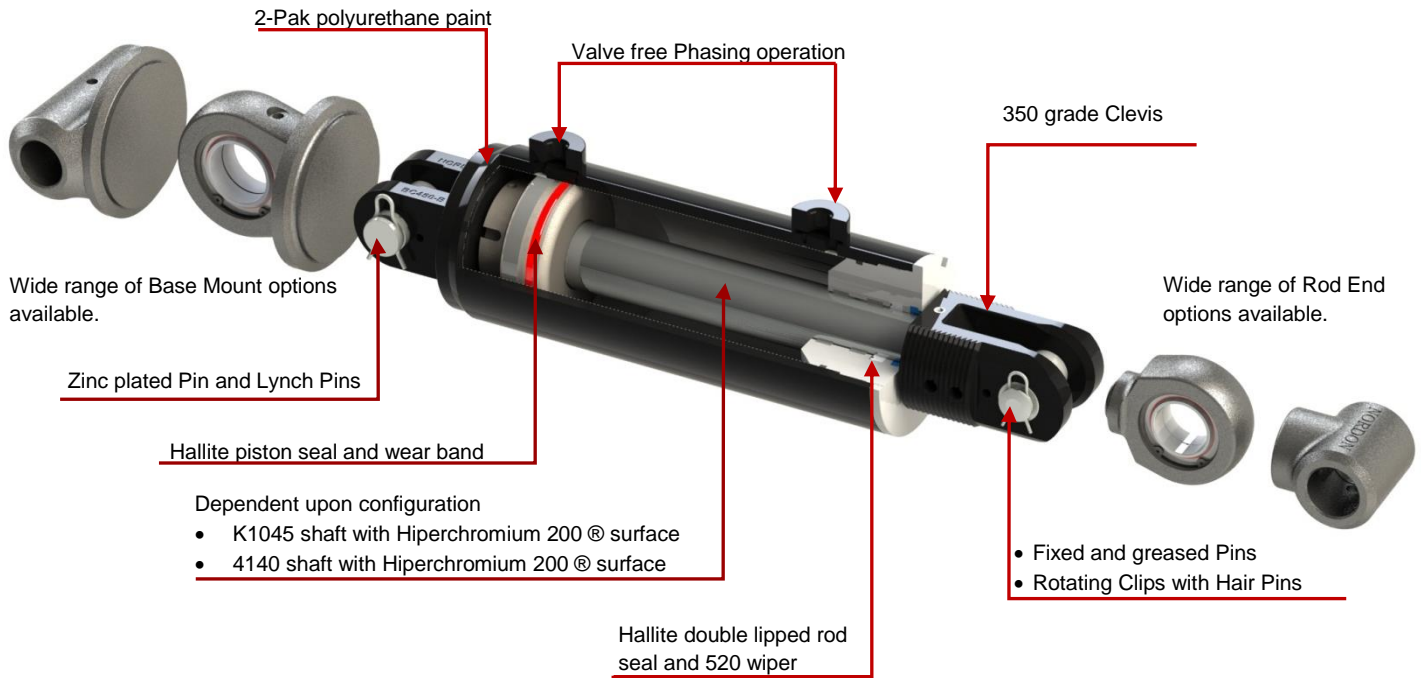

## Nordon Quality

### Nordon exclusive re-phasing ports:

No valves to be affected by contamination and no grooves across the piston seal to cause wear.

### High quality skived and roller burnished tube:

0.1micron RA surface finish results in extended seal life.

### K1045 or 4140 High Tensile shaft

### 4140 rod clevis pins:

greater wear resistance where it is needed most

### Hiperchrome 200 @ hard chrome plating:

200 hours rating 9 corrosion certification mean enhanced corrosion protection

### Hallite 620/621 double lipped rod seal:

Improved sealing performance over a wider range of operating conditions.

### Hallite 520 rod wiper:

Enhanced rod wiping performance and durability.

### 350 grade cast steel clevises:

Provides greater strength and accuracy

### Available Specifications

<b>Bore</b>	from 3" to 5.5" in 1/4 " increments
<b>Stroke</b>	Up to 5 meters and beyond
<b>Mounts</b>	Female Clevis Spherical Bearings Pin Eye Male lug Trunion
<b>Depth Stop</b>	from 3.0" to 5.5" bores
<b>Max Pressure</b>	200* Bar
<b>Max Diff Pressure</b>	160 Bar
<b>Min System Flow</b>	20 ltrs per min
<b>Speed</b>	0.25 meters per second
<b>Duty</b>	Heavy
<b>Colour</b>	Gloss Black 2 Pack

## Nordon NIP Series

Nordon provides the industry leading NI Industrial Phasing range of cylinders - the first and still the only round line cylinder manufactured in Australia. This range is the only industrial cylinder product that offers a complete range of standard mounting and accessories to provide clients with limitless range options.

Featuring high 350 grade steel castings and machined steel mountings which are held in stock, the NI range offers designers a standard product to incorporate within their designs.

**Refer to Specification drawings for dimensions on the full range of options within the NIP Series**

Nordon Cylinders utilises a unique part numbering system that provides comprehensive and unmistakable reference for each and every part.

## NAP Part Numbering Code

# NAP - 35 - A - 12 - C12 - P2

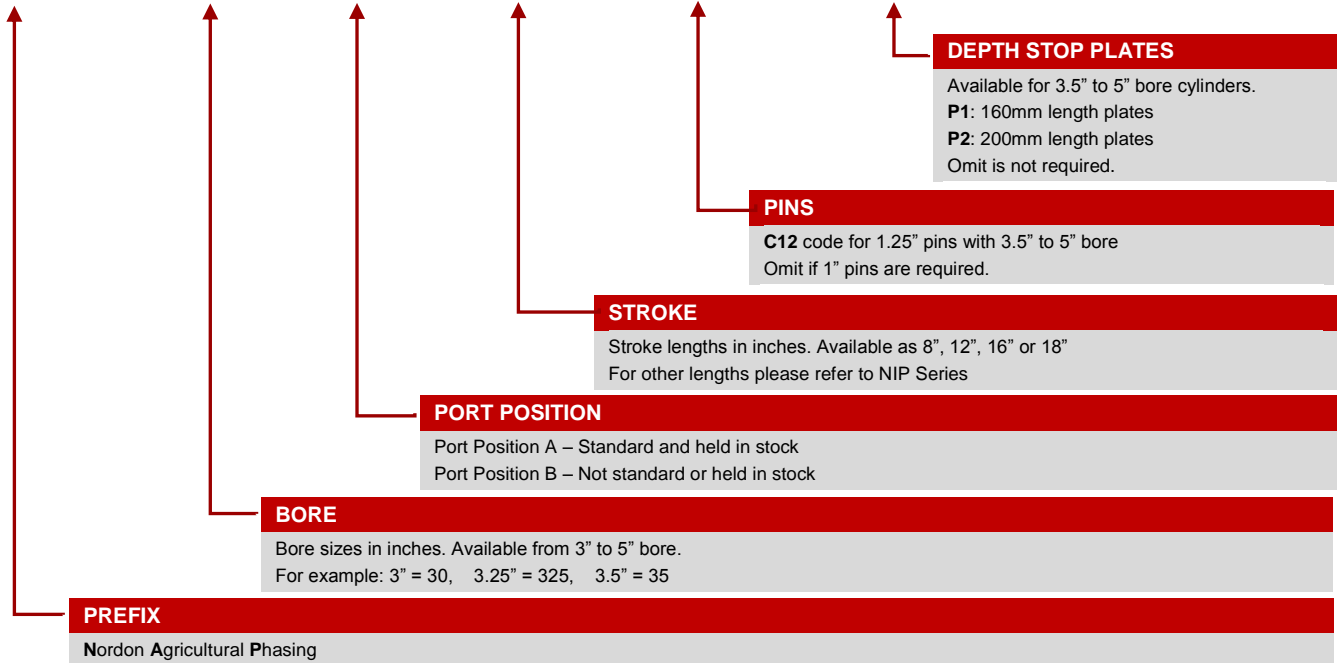

## NHP Part Numbering Code

# NHP - 35 - A - 12 - P2

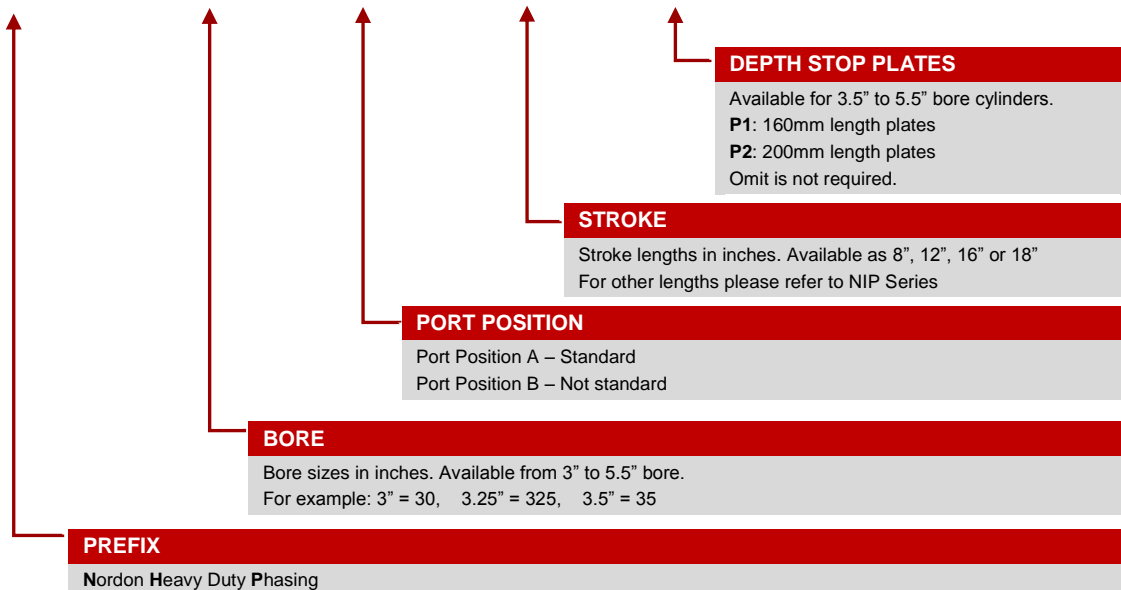

## NIP Part Numbering Code

**NIP- 35 S - C1 S - A S - 1000 S - R13 S - C1 S - R - S4**

### PHASE

**R:** Rod Phase  
**B:** Base Phase  
 Omit if phase both ends

### ROD MOUNT - Special

**S:** special or modified rod

### ROD MOUNT

Rod Mount Code

### ROD - Special

**S:** Special rod conditions

### ROD DIAMETER

Rod diameter in inches  
 For example: 3" = R30, 3.25" = R325, 3.5" = R35  
 NIP Series has a standard rod size for each bore size.  
 Always include the rod code.

### STOP TUBE

Specify length in description. Must use for oversized port holes (on application)

### STROKE

Stroke in mm (do not include mm in part number)  
 Specify as 4 digits eg: 203mm stroke = 0203

### PORT TYPE

**U:** Standard port  
**S:** other ports (on application)

### PORT POSITION

**A:** Standard A or B position  
**X:** other positions

### BASE MOUNT - Special

**S:** special or modified rod mount

### BASE MOUNT

Base Mount Code

### TUBE SURFACE

**S:** SRB (skived and roller burnished). No SSID to be used.

### BORE

Bore sizes in inches. Available from 3" to 5.5" bore. For example: 3" = 30, 3.25" = 325, 3.5" = 35

### PREFIX

Nordon Industrial Phasing

### SPECIAL

Special modifications or depth stops plates to be noted here that have not been noted in other areas. Order depth stop plates separately (not painted)